



Berry Drive, Bromham, Bedford, MK43 8QA
£335,000 Freehold



A much sought after 2/3 bedroom chalet style semi detached house situated in this highly desirable village location with access to all local amenities. The property is presented in excellent order throughout and offers accommodation to include, generous entrance hall and guest cloakroom, dual aspect living room, separate dining room/potential bed 3, kitchen/diner with modern fitted units, two double first floor bedrooms and a modern family bathroom. The property benefits from a driveway at the side and hardstanding at the front which provides parking for up to 4 cars and an unoverlooked, enclosed and established rear garden.

Entrance Canopy

Entrance Hall

Cloakroom

Lounge

14'9 x 12'2 (4.50m x 3.71m)

Bedroom 3/Dining Room

11'10 x 9'11 (3.61m x 3.02m)

Kitchen/Breakfast Room

18'10 x 8'3 (5.74m x 2.51m)

First Floor Landing

Bedroom 1

12'2 x 9'2 (3.71m x 2.79m)

Bedroom 2

15'7 x 9' (4.75m x 2.74m)

Family Bathroom

Exterior

Bromham, Beds

Bromham is considered to be one of Bedford's most highly prized villages and boasts many beautiful listed buildings and

open spaces. Located just to the west of Bedford, Bromham is approximately 2 miles from Bedford Train station which offers transport into Luton in 20 minutes, London St Pancras in under 40 minutes and beyond. Bromham also serves commuters well with direct access to the A428, the M1 J14 and 13 going north and south bound and also to the A1M. Bromham village offers a water mill and a medieval bridge over the River Great Ouse. Local facilities include public houses/restaurants, a village church, lower school, doctors surgery and a Budgens superstore

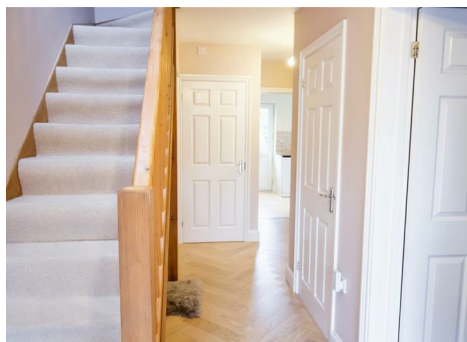
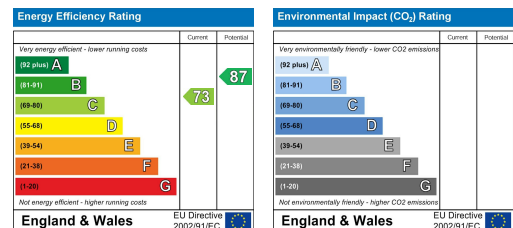
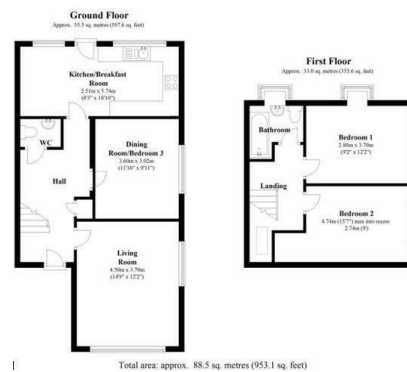

Taylor Made Residential Limited
Taylor House, Roman Gate, Saxon Way, Great
Denham, Bedford, MK40 4FU



01234 302043



bedford@taylormadeproperties.co.uk
www.taylorlandandpropertygroup.co.uk

Company Registration: 10726223 VAT Number: 268 8165 58

